

Add a TAP PAP CS

The TAP PAP CS allows a dreamTAPTM to become a hybrid device, MAD + CPAP

Written By: Patrick Tessier



INTRODUCTION

By adding the TAP PAP CS to a dreamTAP™, the prescriber can provide hybrid therapy for the patient. MAD + CPAP



TOOLS:

- 1.5 mm Locking Screw Hex Key (1)



PARTS:

- TAP PAP CS Post (1)
- TAP PAP NPM Frame (1)

Step 1 — Remove the front plate on the dreamTAP



- Use the 1.5 mm hex driver to remove the locking bolts.
- ⓘ Don't drop the bolts. They are very small and easily misplaced.

Step 2 — Bolt on the Connector Rod

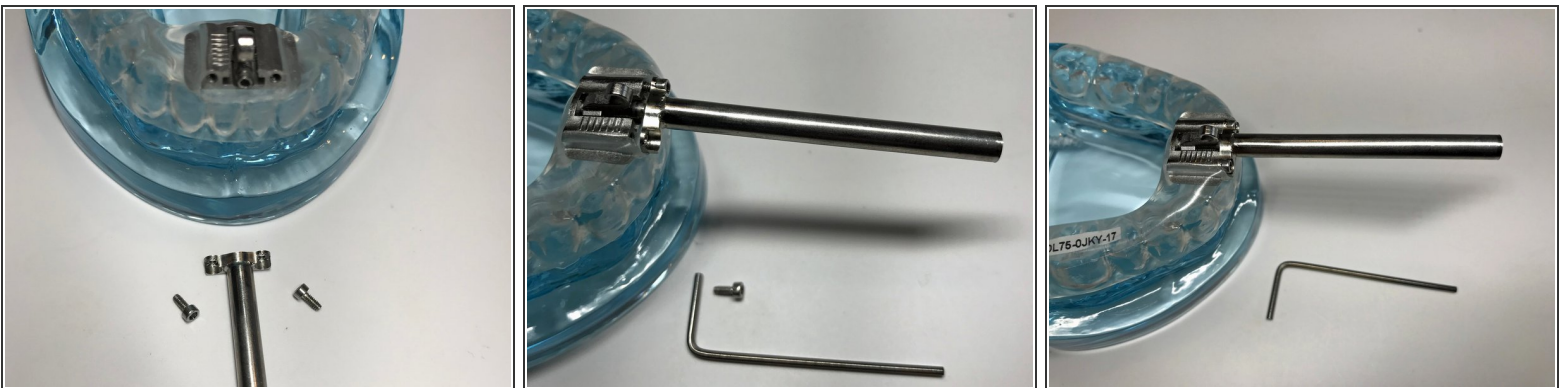

- Screw the connector rod on to the front of the mechanism.
- Use the same bolts you removed in step 1
- ⚠ Don't over tighten the bolts. Snug, but don't strip the threads.

Step 3 — Assemble the Mask



- Use the bolt and nut to assemble the connector interface to the mask
 - This can be adjusted to the patients needs: Up, Down, Forward or Backward
- Finally, slide the interface on to the post. This is a fairly tight fit.